

# Channels (Tapered Flange)

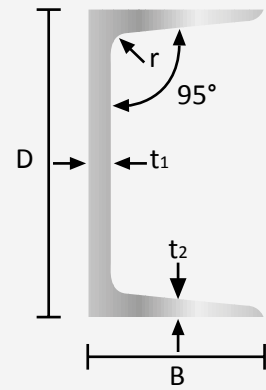

Designation Size	Thickness (t)mm	Unit Weight	Thickness		Root Toe		Sectional Area	Centre of Gravity	Second Moment Of Area		Radius Of Gyration		Elastic Modulus	
			Web	Flange	Radius				I <sub>x</sub>	I <sub>y</sub>	r <sub>x</sub>	r <sub>y</sub>	Z <sub>x</sub>	Z <sub>y</sub>
			t	T	r <sub>1</sub>	r <sub>2</sub>								
D x B x t (mm)		Kg/m	mm	mm	mm	mm	cm <sup>2</sup>	cm	cm <sup>4</sup>	cm <sup>4</sup>	cm	cm	cm <sup>3</sup>	cm <sup>4</sup>
50 x 25	3.5	2.56	5.0	6.0	6	3	4.92	0.81	16.8	2.49	1.85	0.71	6.73	1.48
	4	2.92												
75 x 40	3.8	5.30												
	5	6.92	5.0	7.0	8	4	8.82	1.27	75.9	12.4	2.93	1.19	20.2	4.54
100 x 50	3.8	7.30												
	5	9.36	5.0	7.5	8	4	11.9	1.55	189	26.7	3.99	1.50	37.8	7.82
	6	10.60												
125 x 65	5.2	11.66												
	6	13.40	6.0	8.0	8	4	17.1	1.94	425	65.5	4.99	1.96	68.0	14.4
150 x 75	5.5	14.66												
	6.5	18.60	6.5	10.0	10	5	23.7	2.31	864	122	6.04	2.27	115	23.6
	9	24.00	9.0	12.5	15	7.5	30.5	2.31	1060	151	5.90	2.22	141	29.1
180 x 75	7	21.40	7.0	10.5	11	5.5	27.2	2.15	1380	137	7.12	2.24	154	25.5
200 x 80	7.5	24.60	7.5	11.0	12	6	31.3	2.24	1950	177	7.89	2.38	195	30.8
200 x 90	8	30.30	8.0	13.5	14	7	38.7	2.77	2490	286	8.02	2.72	249	45.9
250 x 90	9	34.60	9.0	13.0	14	7	44.1	2.42	4180	306	9.74	2.63	335	46.5
300 x 90	9	38.10	9.0	12.0	14	7	48.6	2.23	6440	325	11.5	2.59	429	48.0
380 x 100	10.5	54.50	10.5	16.0	18	9	69.4	2.41	14500	557	14.5	2.83	762	73.3

Grades:  
 ASTM A36  
 EN 10025 S275JR, S355JR  
 JIS G 3101 SS400

# LIP CHANNELS

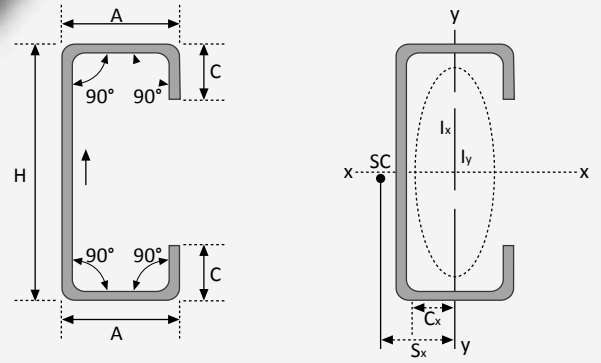

Standard Sectional Dimension		Unit Weight	Sectional Area	Centre of Gravity		Second Moment Of Area		Radius Of Gyration		Elastic Modulus		Centre Of Shear	
				A	C <sub>x</sub>	C <sub>y</sub>	I <sub>x</sub>	I <sub>y</sub>	i <sub>x</sub>	i <sub>y</sub>	Z <sub>x</sub>	Z <sub>y</sub>	S <sub>x</sub>
H x A x C	Thickness t (mm)	kg/m	cm <sup>2</sup>	cm	cm	cm <sup>4</sup>	cm <sup>4</sup>	cm	cm	cm <sup>3</sup>	cm <sup>3</sup>	cm	cm
75 x 45 x 15	1.6	2.32	2.952	0	1.72	27.1	8.71	3.03	1.72	7.24	3.13	4.1	0
	2.3	3.25	4.137	0	1.72	37.1	11.8	3.00	1.69	9.9	4.24	4.0	0
	3.0	4.13	5.258	0	1.71	46	14.25	2.96	1.65	12.27	5.11	4.0	0
100 x 50 x 20	2.3	4.06	5.172	0	1.86	80.7	19.0	3.95	1.92	16.1	6.06	4.4	0
	3.0	5.18	6.608	0	1.86	101	23.4	3.91	1.88	20.2	7.45	4.4	0
	4.0	6.71	8.548	0	1.86	127	28.7	3.85	1.83	25.4	9.13	4.3	0
	4.5	7.43	9.469	0	1.86	139	30.9	3.82	1.81	27.7	9.82	4.3	0
125 x 50 x 20	2.3	4.51	5.747	0	1.69	137	20.6	4.88	1.89	21.9	6.22	4.1	0
	3.0	5.77	7.358	0	1.69	172	25.4	4.83	1.83	27.5	7.56	4.1	0
	4.0	7.50	9.548	0	1.68	217	31.1	4.77	1.81	34.7	9.38	4.0	0
150 x 65 x 20	2.3	5.50	7.012	0	2.12	248	41.1	5.94	2.42	33.0	9.37	5.2	0
	3.0	7.07	9.008	0	2.11	314	51.1	5.90	2.38	41.9	11.7	5.1	0
	4.0	9.22	11.75	0	2.11	401	63.7	5.84	2.33	53.5	14.5	5.0	0
	4.5	10.25	13.07	0	2.10	441	69.2	5.82	2.30	58.8	15.7	5.0	0
175 x 75 x 20	2.3	6.31	8.047	0	2.35	389	61.0	6.96	2.75	44.5	11.8	5.7	0
	3.0	8.13	10.36	0	2.34	495	76.4	6.91	2.72	56.6	14.8	5.7	0
	3.2	8.63	11.01	0	2.34	524.33	80.51	6.90	2.70	59.92	15.61	5.7	0
	4.5	11.84	15.09	0	2.33	702	105	6.82	2.63	80.3	20.2	5.6	0
200 x 75 x 20	2.3	6.76	8.622	0	2.20	531	63.7	7.85	2.72	53.1	12.0	5.5	0
	3.0	8.71	11.11	0	2.19	676	79.8	7.80	2.68	67.6	15.0	5.4	0
	4.5	12.73	16.22	0	2.19	963	109	7.71	2.60	96.3	20.6	5.3	0
200 x 75 x 25	2.3	6.95	8.852	0	2.33	545	69.7	7.85	2.81	54.5	13.5	5.8	0
	3.0	8.96	11.41	0	2.33	694	87.5	7.80	2.77	69.4	16.9	5.7	0
	4.0	11.70	14.95	0	2.32	895	110	7.74	2.72	89.5	21.3	5.7	0
	4.5	13.10	16.67	0	2.32	990	121	7.71	2.69	99.0	23.3	5.6	0
250 x 75 x 20	2.3	7.67	9.772	0	1.95	897	68.1	9.58	2.64	71.8	12.3	5.0	0
	3.0	9.90	12.61	0	1.95	1145	85.3	9.53	2.60	91.6	15.4	4.9	0
	4.0	13.00	16.55	0	1.95	1480	107	9.46	2.54	118	19.3	4.9	0
	4.5	14.50	18.47	0	1.95	1639	117	9.42	2.52	131	21.0	4.8	0
250 x 75 x 25	2.3	7.85	10.00	0	2.08	921	74.8	9.60	2.73	73.7	13.8	5.3	0
	3.0	10.10	12.91	0	2.08	1177	93.8	9.55	2.70	94.1	17.3	5.2	0
	4.0	13.30	16.95	0	2.07	1522	118	9.48	2.64	122	21.8	5.1	0
	4.5	14.90	18.92	0	2.07	1690	129	9.44	2.62	135	23.8	5.1	0

Grades:  
JIS G 3350 SSC400